

Repair Parts

895-317GN2FCXKABCP

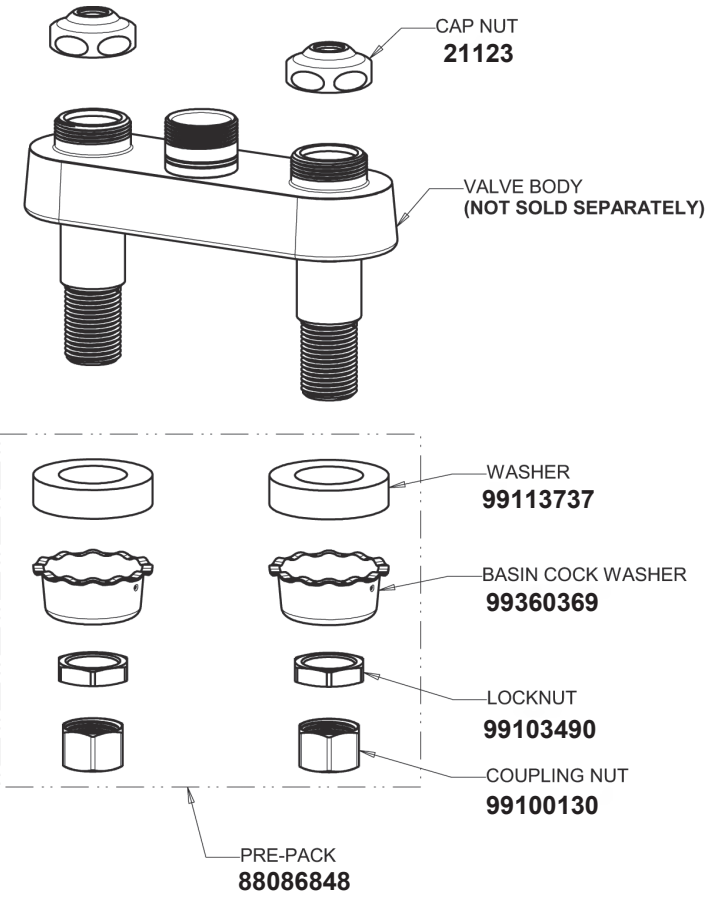

Base Parts:



4" Wristblade Handle 22634

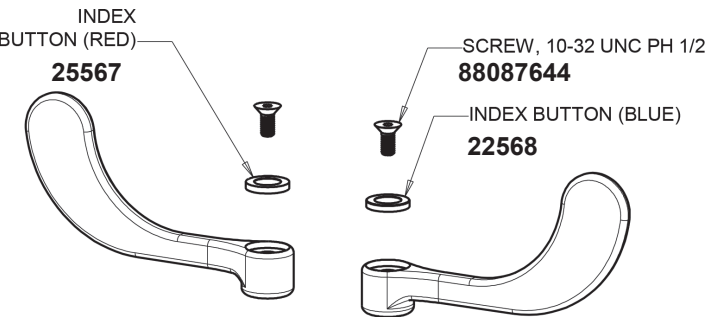

5-1/4" Rigid / Swing Gooseneck Spout 99046561

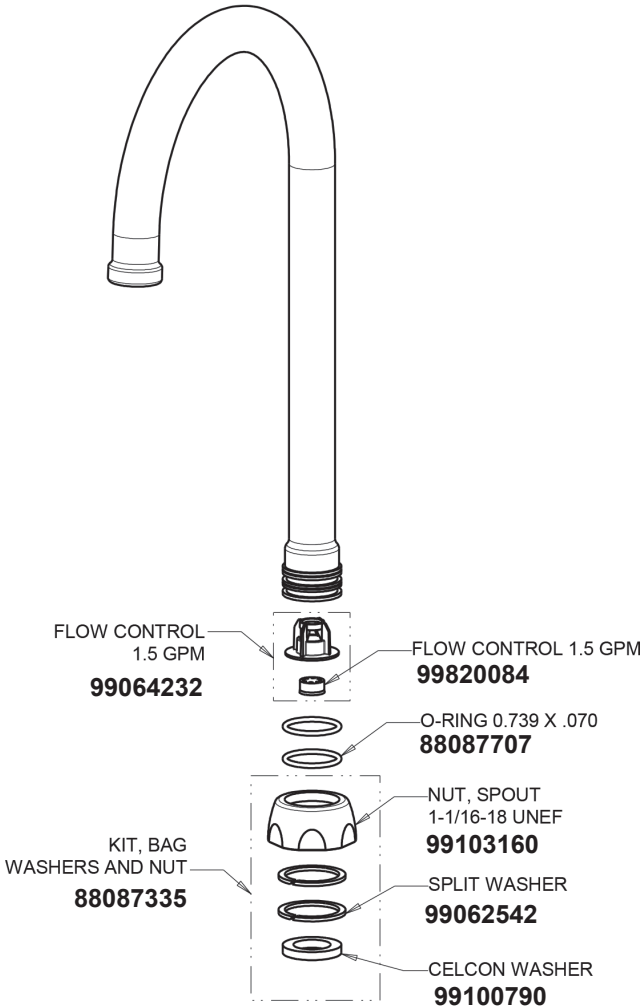

Ceramic 1/4-Turn Cartridge (pair) 99050040 (right) 99050041 (left)

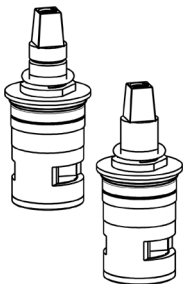

Renewing "XT" Quatern™ or Slow Compression Cartridges

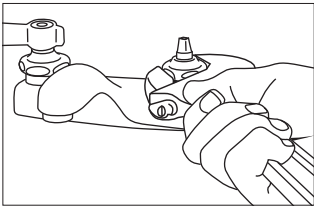

STEP 1 - Turn off water at stop or main valve. Remove handle assembly and with flat face wrench, remove cap nut (A).

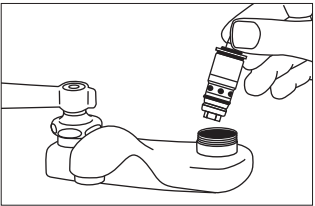

STEP 2 - Remove cartridge from faucet. Flush out any rust or chips that may be in body. DO NOT use file or abrasives to clean out body.

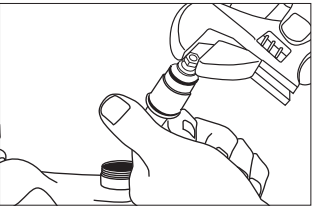

STEP 3 - Unscrew stem nut (K) at the bottom of the cartridge with a flat wrench using a handle as lever to assist removal.

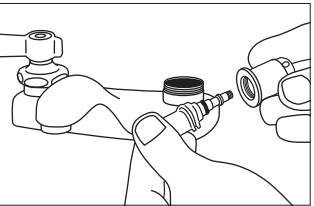

STEP 4 - Turn sleeve (D) off stem (C) by holding handle and turn sleeve by hand. As sleeve is removed from stem, seat (F) O-Ring (G) seat washer (H) retainer (I) and washer (J) will be forced off the stem.

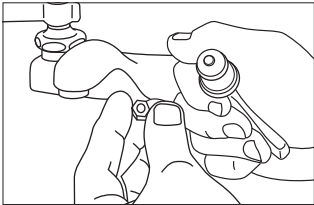

STEP 5 - Reassemble sleeve (D) on lightly lubricated stem (C). With new parts add seat (F) O-Ring (G) seat washer (H) retainer (I) and washer (J) on stem (C) and screw nut tightly on stem.

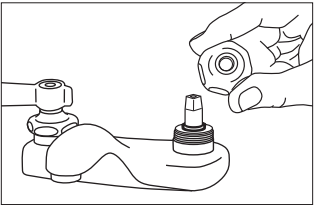

STEP 6 - Reposition washer and O-Ring (B) on stem (C) add to sleeve (D). Replace cartridge in faucet.

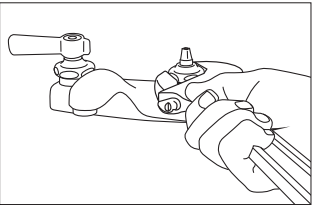

STEP 7 - Replace Cap Nut (A) and partially tighten. Replace handle and rotate cartridge in the direction of closing until the cartridge is in the desired position for convenient operation. Remove handle. Lock cartridge in place by securely tightening Cap Nut (A) to 20 - 27 ft. lbs torque.

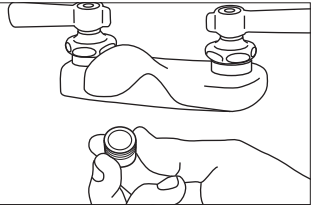

STEP 8 - Turn water on at main valve or stop. Remove aerator. Turn faucet on to "full" allowing sediment to flush from lines and replace aerator cartridge.



BEST PLUMBING SPECIALTIES

800-448-6710 | Fax: 800-700-2378 | www.bestplumbingspecialties.com